

Since the usage and finishing of the product is not under our control, we accept no liability for the success of our products as per the accompanying product data sheets and in accordance with our general terms and conditions of sale. The properties listed here represent no guarantee with respect to the eventual use of our products. We reserve the right to make changes due to technical advances. Any other technical information given in the course of a consultation must be confirmed in writing. Colours shown here are restricted by the printing techniques and may differ from those exhibited by the products themselves. We also reserve the right to make alterations to the product technology or design. Only the current version of this data sheet is valid. Such versions are accessible by anyone via the internet. The issue of the latest data sheet invalidates all those that have been published beforehand.

# DURAPLUS

1/2

## Rectangular Profile

- Information Sheet -

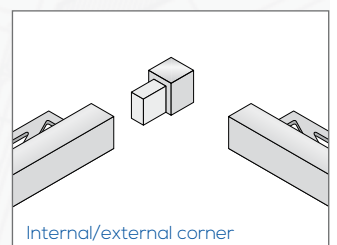
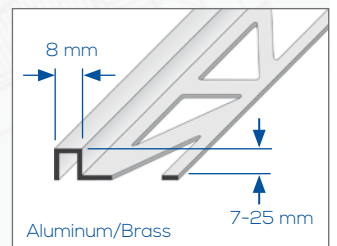
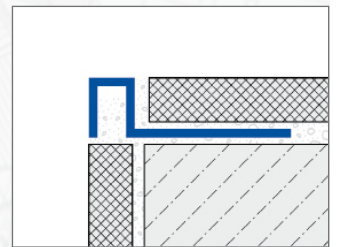
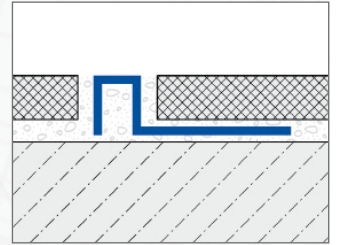

### APPLICATION:

DURAPLUS profiles by Dural have a visible 8 mm width surface area and were developed for improved visual joint design. The application is recommended wherever the flooring material must meet a high aesthetic requirement. For example, showrooms or art galleries. DURAPLUS facilitates a clean separation of different flooring materials, or areas. Besides the decorative function, DURAPLUS provides the edges of the floor with the maximum protection from impact damage.

### MATERIAL:

The following versions of the profiles DURAPLUS are available: Natural aluminum, Anodized aluminum, Natural brass, Polished brass, Chrome plated brass, Stainless steel and Polished stainless steel.

### PROPERTIES:

DURAPLUS profiles of **aluminum** are applicable wherever no exceptional chemical reactions are expected. Careful handling of cement materials is required to avoid corrosion. Because aluminum is sensitive to alkalins, all residues of mortar, tile cement or joint cement have to be immediately removed from all visible surfaces. The profile is to be completely embedded into the contact layer. This avoids cavities to generate where alkaline water might accumulate.

DURAPLUS profiles of **anodized aluminum** are of special refinement and therefore the surface is usually not subject to changes. The visible surfaces however, must be protected against any cement materials. Damages can generate because of scratching or abrasion.

DURAPLUS profiles of **brass** are appropriate for use in residential and commercial areas. They are resistant to major stresses and mostly resistant to chemicals generating during the laying of tiles.

Important: brass oxidizes when exposed to air, especially with high humidity. The surface is covered with a patina (protective layer) and changes its appearance.

DURAL  
711 N Varnell Rd  
Tunnel Hill, GA 30755  
800.278.1956

[www.dural.com](http://www.dural.com)





## Rectangular Trims

### - Information Sheet -

DURAPLUS profiles of stainless steel are especially suitable for areas subjected to high stresses due to chemicals and acids. They meet highest requirements of resistance to mechanical impact. Stainless steel profiles are ideal for commercial projects

For all products and materials, the following applies: The suitability of the material with regard to the expected mechanical loading and chemical exposure must be investigated carefully in each individual case. The generally recognized rules of good engineering practice must always be observed!

#### HANDLING:

1. Select the DURAPLUS profile according to the thickness of tiles.
2. Apply tile cement in the appropriate area using a notched trowel.
3. Press the DURAPLUS profile into the cement bed and align.
4. Completely cover the fastening legs.
5. Press the tiles tightly into the cement bed and align them flush with the upper profile edge.
6. Leave a joint of 2-3 mm between tile and profile.
7. Use the matching inside/outside corner pieces if applicable.
8. Fill the space between tiles and profile completely with joint grout.
9. Adhesive and grout should always be removed immediately from all visible surfaces using plenty of water

#### CARE AND MAINTENANCE:

DURAPLUS profiles do not require any special care. Oxidation layers can be removed with polishing material. A permanent removal however is not possible. The cleaning materials must be free of hydrochloric acid and hydrofluoric acid and must not be abrasive.

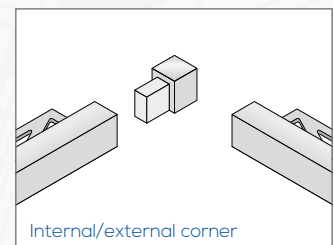
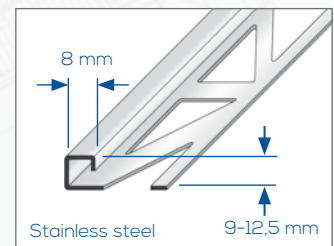
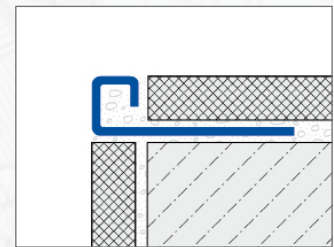
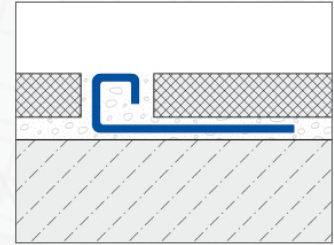

#### DATASHEET:

MATERIAL:	<ul style="list-style-type: none"> <li>- Natural aluminum</li> <li>- Anodized aluminum</li> <li>- Natural brass</li> <li>- Polished brass</li> <li>- Chrome plated brass</li> <li>- Stainless steel V2A (1.4301)</li> <li>- Polished stainless steel V2A (1.4301)</li> </ul>
HEIGHT OF PROFILE:	Aluminum/Brass: 7-25 mm, Stainless steel: 9 / 11 / 12.5 mm
LENGTH OF PROFILE:	250 cm
APPLICATION:	Corner pieces for internal and external corner

DURAL  
711 N Varnell Rd  
Tunnel Hill, GA 30755  
800.278.1956

[www.dural.com](http://www.dural.com)